

ISPOR Real-World Evidence Summit 2025

Through the Lens of Asia Pacific | 28-30 September

Program Guide

Sunday, 28 September

7:30 - 17:00 Registration Hours *Sunflower White*

8:00 - 12:00 Morning Short Courses

01 Introduction to Applied Generative AI for HEOR *Suehiro*

02 Health Technology Assessment for Rare Diseases *Takasago*

13:00 - 17:00 Afternoon Short Courses

03 Causal Inference and Causal Estimands From Target Trial Emulations Using Evidence From Real-World Observational Studies and Clinical Trials *Suehiro*

04 Critical Steps to Construct a Budget Impact Analysis *Takasago*

Monday, 29 September

6:30 - 8:00 Welcome Coffee *Providence Hall*

6:30 - 18:00 Registration Hours *Sunflower White*

7:00 - 8:00 Member Group Meeting

ISPOR Asia Consortium Meeting *Sunflower Hall*

8:00 - 9:15 Plenary Session *Ho-O-no-Ma 1*

05a Welcome Remarks

05b Realizing RWE Potential in Asia Pacific: Opportunities, Challenges, and Progress

9:15 - 9:45 Morning Coffee Break *Providence Hall*

9:45 - 10:45 Concurrent Breakout Sessions

06 Translating Real-World Evidence Into Policy: A Comparative Analysis of Adoption Mechanisms in China and the US Drug Price Negotiations *Ho-O-no-Ma 1*

07 Harnessing RWD for Evidence-Based HTA in Asia-Pacific: Data Challenges, Evolving Paradigms and Empirical Applications *Ho-O-no-Ma 2*

08 Fit-for-Purpose Data in Value Assessment in Japan: How Best to Leverage Real-World Evidence (RWE) and Qualitative Value Elements to Optimize Decision Analysis *Sunflower Hall*

10:45 - 11:15 Networking Break *Providence Hall*

11:15 - 12:15 Concurrent Breakout Sessions

09 Equity-Informative Real-World Evidence: Learning From Global Lessons and Exploring Future Initiatives *Sunflower Hall*

10 Harnessing Big Data, AI, and Real-World Evidence to Transform Regulatory and Health Technology Assessment in APAC *Ho-O-no-Ma 2*

11 HTA System in Japan: Progress and Issues *Ho-O-no-Ma 1*

WIFI Network: ISPORRWEsummit2025

Password: ISPORSummit



SCAN TO
DOWNLOAD OUR
MOBILE APP

12:15 - 13:15 Lunch *Providence Hall*

12:15 - 13:15 Member Group Meetings

ISPOR Australia Chapter Meeting *Kobai*

ISPOR Japan Chapter Meeting *Golden Cup*

13:15 - 14:15 Concurrent Breakout Sessions

12 Informing Health Policy Decisions Through Meta-Analysis of Economic Evaluations: Why and How to Do It? How to Connect With Users? *Ho-O-no-Ma 1*

13 Learning From the COVID-19 Pandemic and Designing a New HEOR Research Model: What is the Role of Real-World Evidence and How Does It Work? *Ho-O-no-Ma 2*

14 Nordic-Asia Pacific Collaboration in Real-World Evidence Studies: Lessons Learned and Opportunities for Future Research Networks *Sunflower Hall*

14:15 - 15:15 Poster Session 1 *Providence Hall*

14:15 - 15:15 Member Group Meeting

ISPOR Korea Chapter Meeting *Golden Cup*

15:15 - 16:15 Concurrent Breakout Sessions

15 Enhancing Expert Education in HTA: Challenges and Lessons From Thailand *Ho-O-no-Ma 2*

16 How to Collect PROs in RW Studies and Leverage Them for Robust Evidence Generation? ISPOR Good Practices Task Force on Patient Reported Outcomes (PROs) in Prospective Real-World Studies: Emerging Recommendations & Next Steps *Sunflower Hall*

17 Use of Real-World Evidence in Medical Device HTA Evaluations: Lessons Learned From Australia and Japan *Ho-O-no-Ma 1*

16:15 - 16:45 Afternoon Coffee Break *Providence Hall*

16:45 - 17:45 Educational Symposia

18 Advances in Real-World Evidence and AI Applications: Aligning Global Objectives With Local Data Realities *Ho-O-no-Ma 1*
Sponsored by Corporate Partner, Analysis Group

19 Integrating Patient and Caregiver-Generated Data to Capture Broader Societal Value in Cost of Illness and Value *Ho-O-no-Ma 2*
Sponsored by Oracle Life Sciences

17:45 - 18:45 Networking Reception *Providence Hall*

ISPOR Real-World Evidence Summit 2025

Through the Lens of Asia Pacific | 28-30 September

Tuesday, 30 September

7:30 - 8:00 Welcome Coffee *Providence Hall*

7:30 - 16:30 Registration Hours *Sunflower White*

8:00 - 9:00 Concurrent Breakout Sessions

20 How to Address Evidence Uncertainties via Real-World Evidence Generation in Cancer Drug Fund in Taiwan
Sunflower Hall

21 The Promise of OMOP and Database Research at Scale in APAC: Opportunities and Gaps *Ho-O-no-Ma 1*

22 Generative AI in RWE: Real-World Impact and the Road to Reliable Evidence for Decision Making *Ho-O-no-Ma 2*

9:00 - 9:30 Morning Coffee Break *Providence Hall*

9:30 - 10:30 Concurrent Breakout Sessions

23 Culture-Specific Health-Related Quality of Life Measurement: Is It Necessary for Asia? *Ho-O-no-Ma 1*

24 Real-World Evidence in China: How Can It Transform China's Healthcare Landscape? *Sunflower Hall*

25 How Is Real-World Evidence Supporting Conditional Listing and Health Technology Reassessment? *Ho-O-no-Ma 2*

10:30 - 11:00 Networking Break *Providence Hall*

11:00 - 12:00 Educational Symposium

26 The Unseen Liver Disease MASH: The Cost of Inaction on an Underdiagnosed Metabolic Disease and Challenges in the Asia Pacific *Ho-O-no-Ma 2*

Sponsored by Novo Nordisk A/S

12:00 - 13:00 Lunch *Providence Hall*

12:00 - 13:00 Member Group Meetings

ISPOR Beijing Chapter Meeting *Kobai*

ISPOR Taiwan Chapter Meeting *Golden Cup*

13:00 - 14:00 Poster Session 2 *Providence Hall*

14:00 - 15:00 Spotlight Session

27 Unlocking Local Insights: Strengthening HTA With Real-World Evidence Across Asia Pacific *Ho-O-no-Ma 2*

This session is a collaboration between ISPOR and HTAsiaLink.

15:00 - 15:15 Afternoon Coffee Break

15:15 - 16:30 Plenary Session *Ho-O-no-Ma 1*

28a Closing Remarks

28b Building the Future: Advancing Real-World Evidence in Asia Pacific and Beyond

Floor Plan

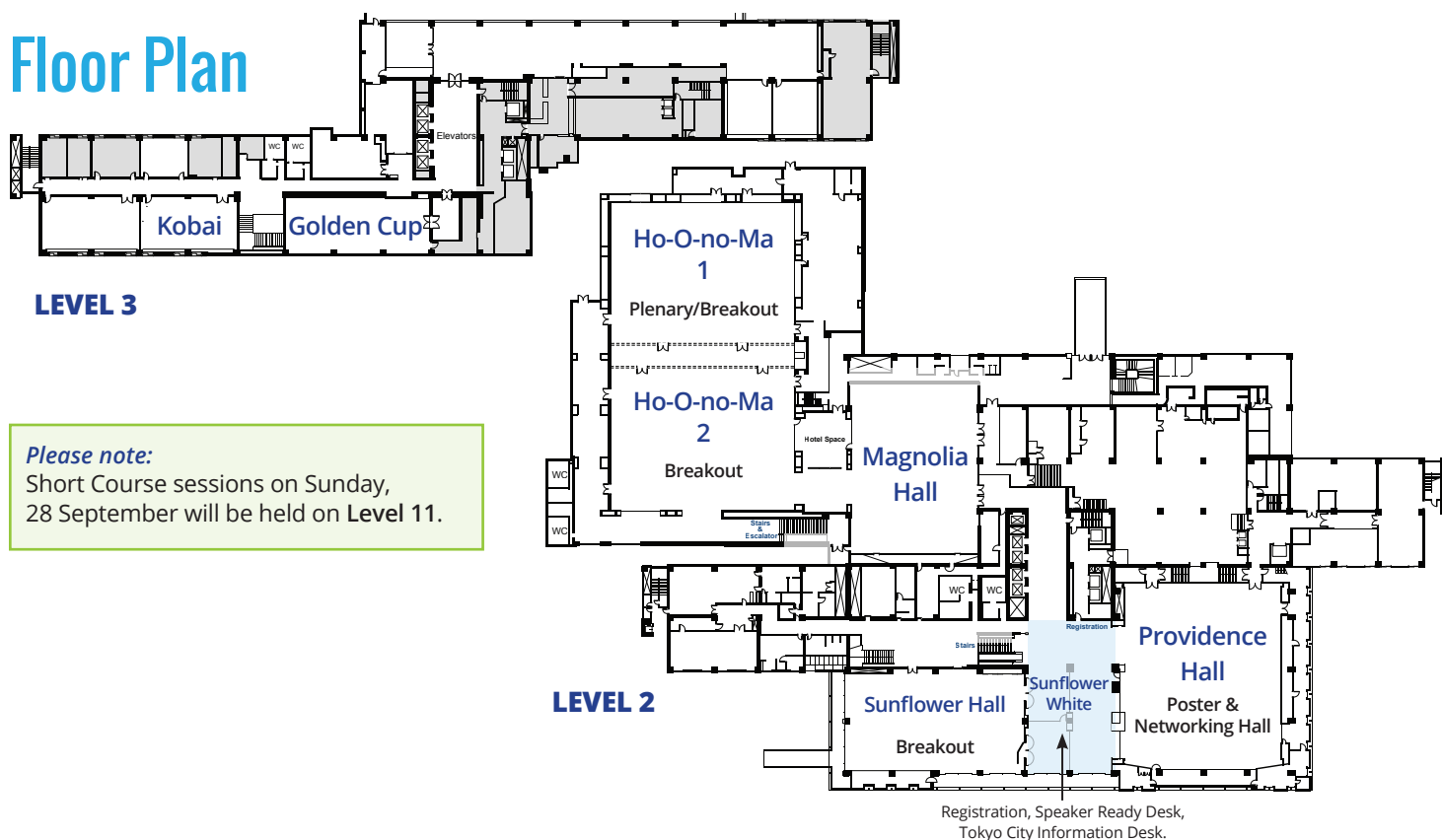

Please note:

Short Course sessions on Sunday, 28 September will be held on Level 11.