



## Attendee Guide

This guide will help you easily find everything you need to make the most of your Summit.

## Table of Contents

• Overview.....	1
• Educational Programming.....	1
• General On-Site Information.....	4

## Overview

The ISPOR Real-World Evidence Summit 2025: Through the Lens of Asia Pacific is the must-attend health economics and outcomes research (HEOR) and real-world evidence (RWE) event in Asia Pacific. The Summit brings together top experts, decision makers, and industry leaders to explore the latest breakthroughs, share cutting-edge research, and discuss innovative solutions to the region's most pressing healthcare challenges.

## Educational Programming

### Short Courses

Attendees can enhance their #ISPORSummit experience by attending short courses on Sunday, 28 September. Short Course registration is an additional, separate registration fee.

Sunday, 28 September | 8:00 - 12:00

- [01: Introduction to Applied Generative AI for HEOR](#)
- [02: Health Technology Assessment for Rare Diseases](#)

Sunday, 28 September | 13:00 - 17:00

- [03: Causal Inference and Causal Estimands From Target Trial Emulations Using Evidence From Real-World Observational Studies and Clinical Trials](#)
- [04: Critical Steps to Construct a Budget Impact Analysis](#)

If you have already registered to attend the Summit and would like to now add a short course, follow the steps below.

- Log in to your ISPOR account.
- Under Manage Profile, you will see a drop-down menu on the right side of the page under My Account Links.

- Select My Events. Then choose ISPOR 2025 and look for the Add Short Courses button on the right side of the page. This will bring you to the Short Course sessions.
- Select the sessions that interest you, Add to Cart, and Check Out!

## Poster Sessions

Poster sessions on Monday, September 29, and Tuesday, September 30, in Providence Hall will showcase cutting-edge research. [View poster abstracts](#) and plan your way through this vast array of research.

## Member Group Meetings

Attend one of the Member Group Meetings to connect with colleagues, get updates on local initiatives, ongoing policy developments, and upcoming chapter activities.

[View the Member Group Meetings here.](#)

## Navigate the Program

Attendees can view the program online, through the mobile app, and as a PDF. Find the viewing option that works best for you and begin to plan your ISPOR Real-World Evidence Summit 2025 experience! Click below to view the program in your preferred format. Please note, printed copies will not be available onsite. If you prefer to carry a printed copy of the Program, please be sure to print in advance.

### [Online Program](#)

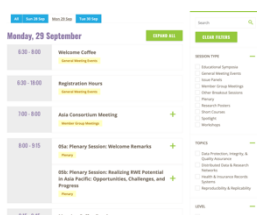

*best for a large screen view of the program*

### [Mobile App](#)



*best for networking, compiling your schedule, and quick handheld access to the program*

### [PDF Program](#)



*best for those who prefer a print copy of the schedule-at-a-glance*

Navigate your way around the Tokyo Prince Hotel with this floor plan to easily find sessions, registration, and other meeting rooms.

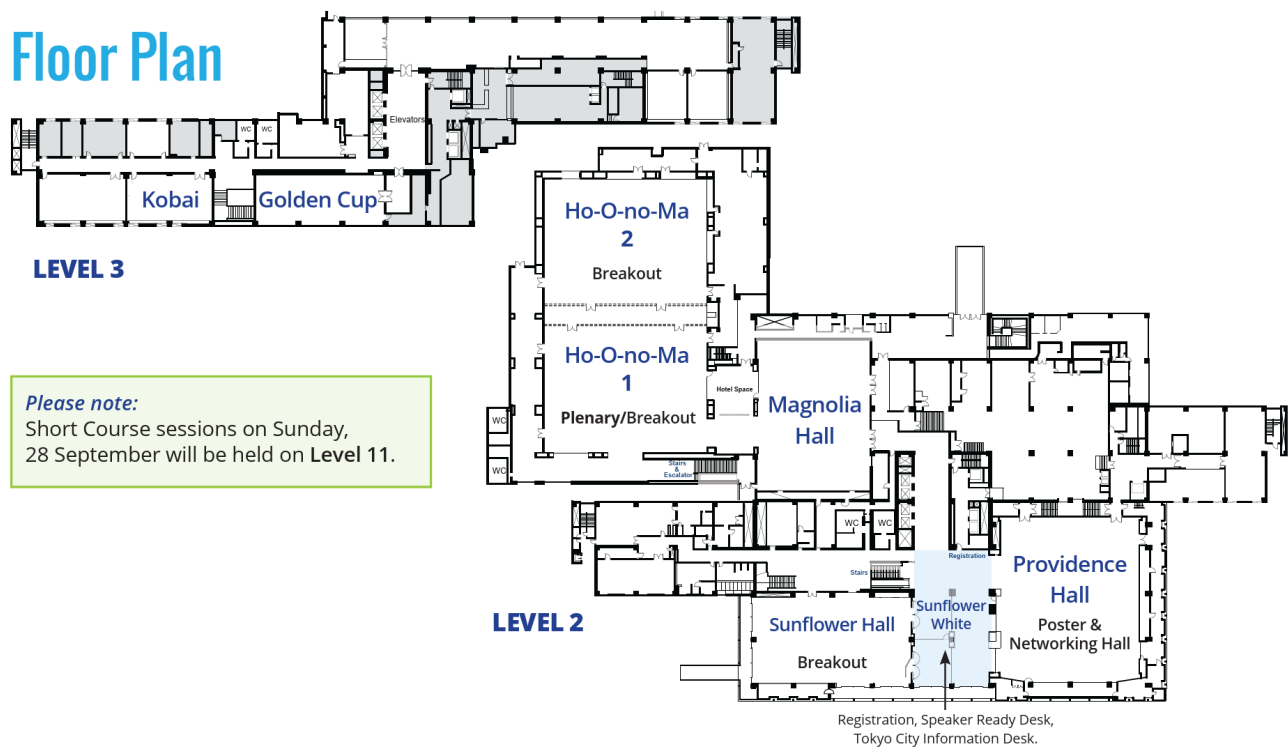

## Baby Care Room

Located on Lobby Level, 1F and open 24 Hours.

## Speaker Ready Desk

Speaker Ready Desk will be available to Session Presenters Sunday-Tuesday, located in Sunflower White, Level 2.

Speaker Ready Room Hours:

- Sunday, 28 September | 7:30-17:00
- Monday, 29 September | 6:30-17:00
- Tuesday, 30 September | 7:30-12:00

## Tokyo City Information Desk

Tokyo City Desk will be available Sunday-Tuesday located in Sunflower White, Level 2.

Tokyo City Desk Hours:

- Sunday, 28 September | 9:00-18:00
- Monday, 29 September | 9:00-17:00
- Tuesday, 30 September | 7:30-18:00

## Multi-Faith Prayer Room

The Multi-Faith Prayer Room is located in Aoi, Level 4.

### Hours of Operation

- Monday, 29 September | 6:30-18:45
- Tuesday, 30 September | 7:30-14:30

## Food and Beverage

All dining options available to ISPOR attendees are listed below and provided in Providence Hall unless otherwise noted.

### *Morning Service*

- Monday, 29 September | 6:30-8:00
- Tuesday, 30 September | 7:30-8:00

### *Coffee Breaks*

- Monday, 29 September | 9:15-9:45, 10:15-10:45, 16:15-16:45
- Tuesday, 30 September | 9:00-9:30, 10:30-11:00, 14:00-14:30

### *Lunch*

- Monday, 29 September | 12:15 – 13:15
- Tuesday, 30 September | 12:00 – 13:00

Please Note: ISPOR does not provide lunch on Sunday, 28 September. Food options are available for purchase on Level 1 at the Tokyo Prince Hotel.

### *Welcome Reception*

- Monday, 29 September | 17:45-18:45

### *Dining Options Not Provided by ISPOR*

- There are additional dining options located on Level 1 of the hotel. Options are limited between 15:00-17:00.
- Lawson Convenience Store is located on Level 1 and open from 7:00-23:00.

## Questions?

Please contact [summits@ispor.org](mailto:summits@ispor.org) or visit ISPOR Registration and Help Desk in Sunflower White, Level 2 while in Tokyo.